

receptacle_with_break_away_and_push_pull_locking_for_front_and_rear_panel_mounting_with_cable_outlet

size: 1, IP50, keying: 0, number_of_contacts: 8, solder_cup, contact_type: sockets, Ethernet/IP® [1 Gbit/s]



Basic information

Part number	G51LOC-PD8LCDO-0000
Category	connector
Type of connector	receptacle
Assembly situation	front_panel_mounting, rear_panel_mounting
Size	1

Contact insert description

Special features	data_transmission
Transmission type	Ethernet/IP® [1 Gbit/s]
Number of contacts	8
Contact type	sockets
Contact diameter	0.5 mm
Termination type	solder_cup
Termination diameter	0.65 mm
Wire cross section AWG	AWG 26

Technical information

Nominal current single contact	5 A	IEC 60512-5-2:2002 [DIN EN 60512-5-2:2003]
Max. current insert	3.9	VDE 0298-4:2003
Test voltage	750 V	SAE AS 13441:1998 method 3001.1
Max. creepage distance (contact to contact)	0.5 mm [Contact to housing]	
Max. creepage distance (contact to housing)	1.0 mm [Contact to housing]	
Max. clearance distance (contact to contact)	0.5 mm [Contact to contact]	
Max. clearance distance (contact to housing)	1.0 mm [Contact to housing]	

Mechanical and environmental data

Locking principle	break_away , push_pull
Mating cycles	5.000
IP class	IP50
Max. operating temperature	120 °C
Min. operating temperature	-40 °C
Tightening torque	2.5 Nm
Weight	9.76 g

Material and surface treatments

Material	cu_alloy_with_chrome_finish
Contact material	cu_alloy_with_gold_finish

DIMENSIONS

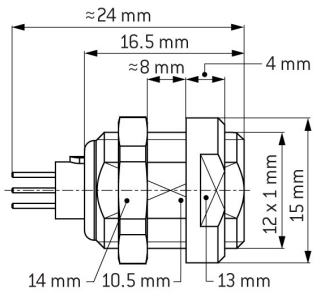

CODING: 0°



POSITIONS: 8 positions

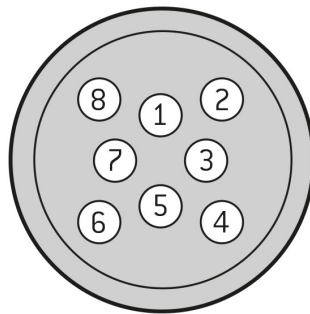

PANEL CUT OUT:

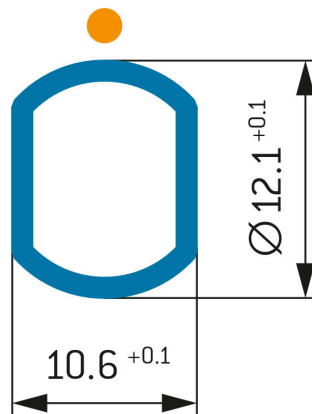

Further technical information and downloads

Connection diagram

connection_diagram_8_pin_ethernet_1gbs_10gbs_rj45

[3D-File \(STP File\)](#)

[Technical specifications](#)