

receptacle_with_break_away_and_push_pull_locking_for_front_and_rear_panel_mounting_with_cable_outlet

size: 0, IP50, keying: a, number_of_contacts: 5, pcb, contact_type: sockets, Signal

Basic information

| | |
|---------------------------|--|
| Part number | G50LAC-P050F00-0000 |
| Category | connector |
| Type of connector | receptacle |
| Assembly situation | front_panel_mounting, rear_panel_mounting |

Contact insert description

| | |
|-----------------------------|---------|
| Transmission type | Signal |
| Number of contacts | 5 |
| Contact type | sockets |
| Contact diameter | 0.7 mm |
| Termination type | pcb |
| Termination diameter | 0.5 mm |

Technical information

| | | |
|---|-----------------------------|--|
| Nominal current single contact | 6 A | IEC 60512-5-2:2002 (DIN EN 60512-5-2:2003) |
| Max. current insert | 4.5 | VDE 0298-4:2003 |
| Test voltage | 1.1 kV AC | SAE AS 13441:1998 method 3001.1 |
| Max. creepage distance (contact to contact) | 0.7 mm (Contact to housing) | |
| Max. creepage distance (contact to housing) | 0.8 mm (Contact to housing) | |
| Max. clearance distance (contact to contact) | 0.7 mm (Contact to contact) | |
| Max. clearance distance (contact to housing) | 0.8 mm (Contact to housing) | |

Mechanical and environmental data

| | |
|----------------------------|------------------------|
| Locking principle | break_away , push_pull |
| Keying | coding_30° |
| Mating cycles | 5.000 |
| IP class | IP50 |
| Max. operating temperature | 120 °C |
| Min. operating temperature | -40 °C |
| Tightening torque | 1.3 Nm |
| Weight | 4.83 g |

Material and surface treatments

| | |
|------------------|----------------------------------|
| Material | cu_alloy_with_matt_chrome_finish |
| Contact material | cu_alloy_with_gold_finish |

DIMENSIONS

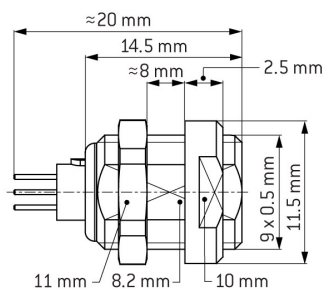

CODING: 30°



POSITIONS: 5 Positions

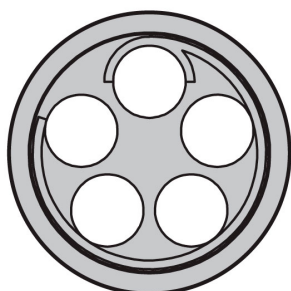

Contact borehole: $\varnothing 0.6$ mm

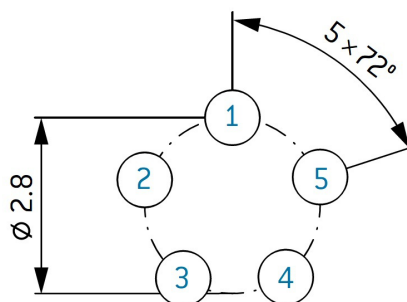

PANEL CUT OUT:



Further technical information and downloads

[3D-File \(STP File\)](#)

[Technical specifications](#)